

FLEX O2

Patient-controlled flow restriction of oxygen supply from oxygen concentrators.

Introduction

Your doctor has determined that oxygen supplements would be beneficial to you and has prescribed two oxygen levels, one dose during exertion and one dose during rest.

To avoid having to move to the oxygen concentrator to adjust the dose, you have the FlexO2 connected with reach, for example hanging around your neck, so that you can then yourself select between these doses in a safe way.

In this way, you can, for example, when seated or lying down change from rest mode to activity mode (see image 2) without having to move and exert yourself unnecessarily.

When changing from rest to activity mode, you turn the handle so that it points to the larger symbol. You get a short "puff" that can be felt and is audible. The puff is completely normal and it shows that the activity flow is selected.

When you change FlexO2 back from activity to rest, turn the handle so that it points to the smaller symbol (see image 4). You will now get an oxygen dose adapted for rest.

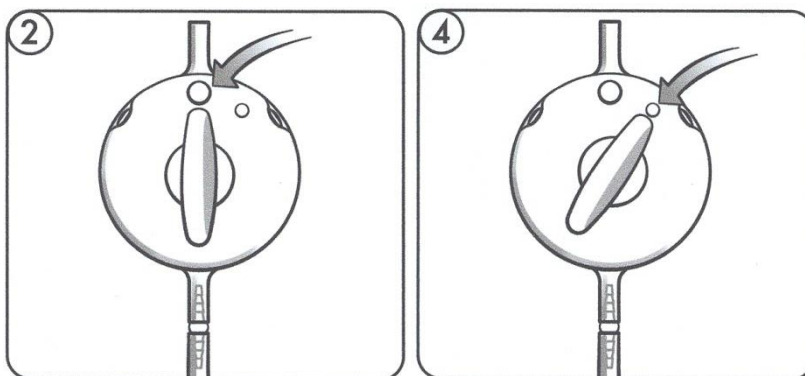

S-hook

An S-hook can be used (not included) where one half is fastened to a hole in the patient's trousers, belt or button hole as close as possible to the midpoint vertically under FlexO2.

See image 10A and 10B.

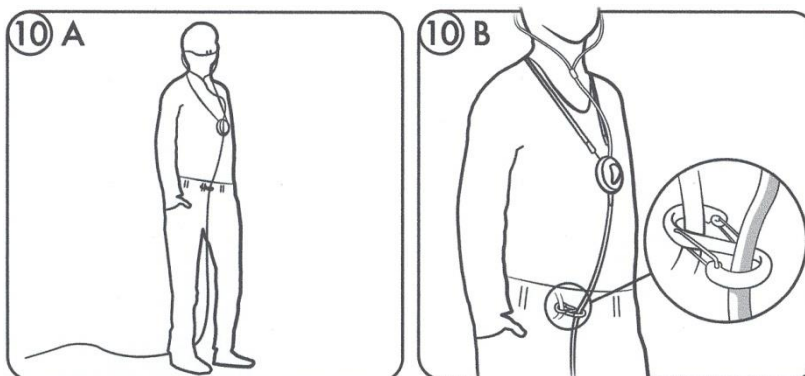

When you enter your house with the tube attached problems can often arise with the tube getting caught. To avoid this happening, ensure that the tube from the oxygen concentrator to FlexO2 is allowed to hang vertically, guided by the S-hook and hanging down between your legs and backwards. See image 10A.

When you change direction, your legs steer the tube up and direct it backwards so that it follows your body. This way the tube does not get caught up as easily and thereby the risk of falling is reduced.

The risk of the tube getting bent out of shape or twisted is also minimal. The tube is loosely coupled in its part of the S-hook and cannot get caught. This facilitates visits to the bathroom, for example.

Showering

FlexO2 must be protected from moisture. When showering, change the nasal cannula with a short tube to a nasal cannula with a longer tube. This allows the device to be hung at the side of the shower and thereby protected from moisture whilst remaining easily accessible if the dose needs to be changed.

Safety Precautions

Ensure that the device is set for you and your prescribed oxygen dose before you start using it. Ensure that rest mode is selected when resting, so as not to get too high an oxygen level. Check at regular intervals that your prescribed oxygen level is correct. This is done by reading the ball in the flow meter on the oxygen concentrator during rest and activity. See image 3.

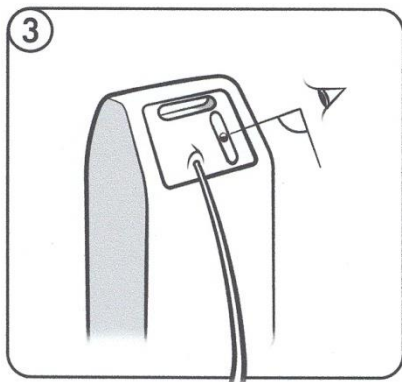

Regularly check the connection pipes and their function so that the couplings are secure (not loose).

Connect a longer nasal cannula to FlexO2 when going to bed. The equipment can be hung on a hook beside the bed and be easily accessible.

Cleaning

Wipe clean using a damp cloth. The device can withstand normal disinfectants.

Service

Contains no user-serviceable parts.

Neck strap

The device comes with a neck strap which is attached to the two upper attachment points on FlexO2. To attach a neck strap to FlexO2, the fittings at each end of the strap separate into two parts. Take the loose part, thread the loop through the hole in FlexO2. Then push the fitting through the loop and tighten so the fittings are joined together. Repeat with the other fitting. See image 8.

The strap allows the load to be moved from the ears to neck and to be balanced over a larger area.

The strap is adjustable and has an added safety mechanism which separates the strap if the user gets caught in something.

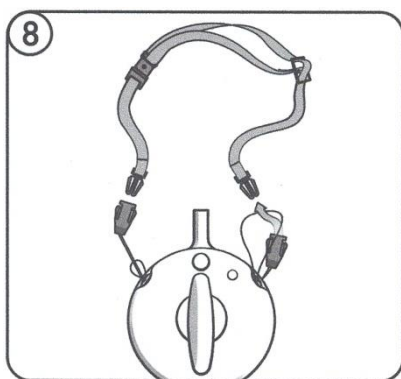

Operating time

When two (2) months of use have passed, the unit should be replaced. Date of last use can be viewed at the back of the unit.

IMPORTANT The manufacturer guarantees the device for a maximum of two (2) months after first use. After this time the device may not be used and the product is no longer approved for use. In the event of damage or suspected damage, the unit must be replaced.

Disposal

Discard as combustible waste.



LungFlex AB
Garvaren
SE-341 60 Ljungby
info@lungflex.com
www.flexo2.com



0402



Rev. 2022-09-04